

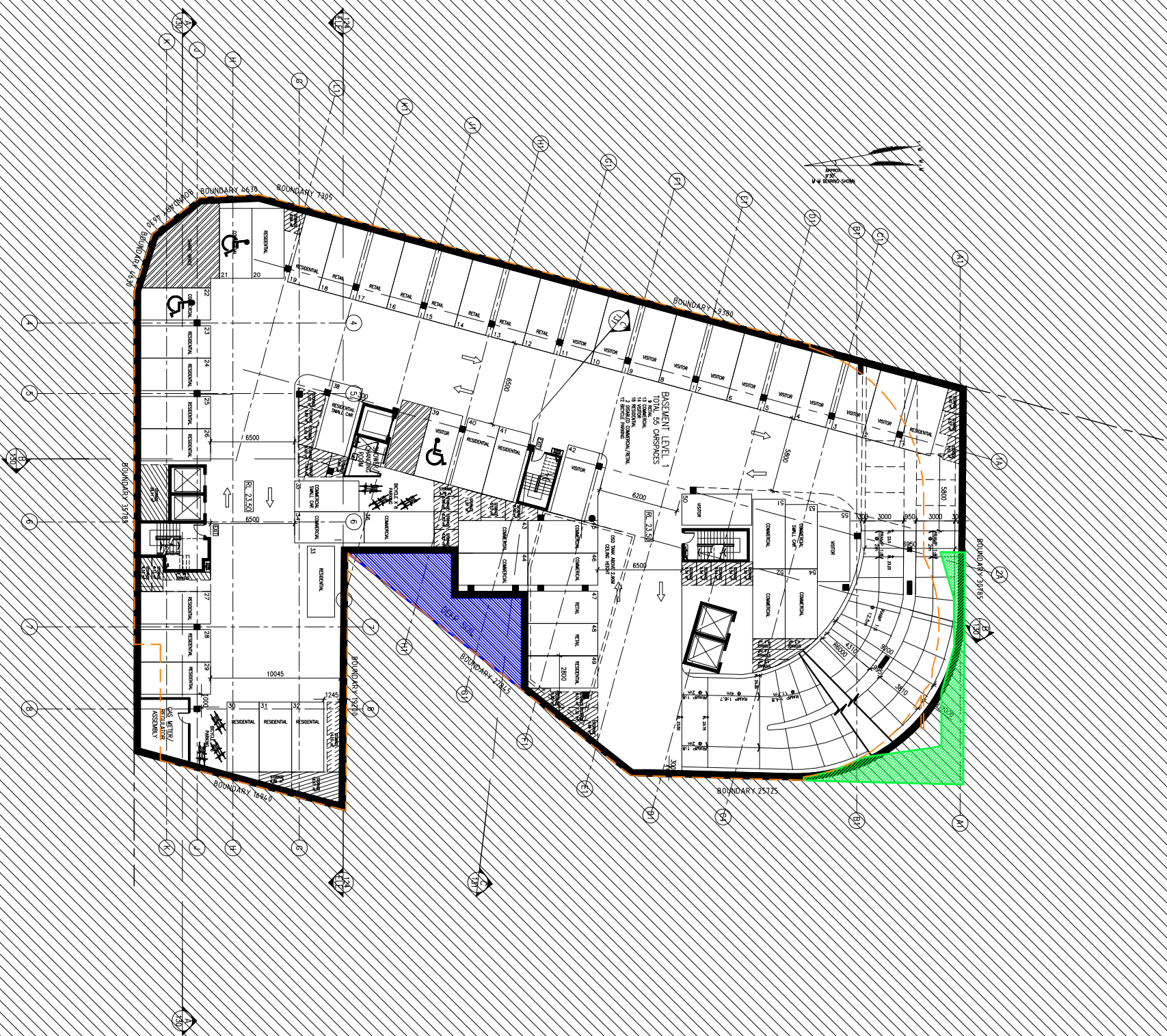

[illegible]

DEEP SOIL ZONE		
STAGE	AREA	PERCENTAGE OF SITE AREA
APPROVED DA AREA	43.16 M ²	1.88%
CURRENT SCHEME	52.39 M ²	2.88%
APPROVED DA DEEP SOIL ZONE  		
CURRENT SCHEME DEEP SOIL ZONE		

APPROVED DA
BUILDING OUTLINE

Project: CHAPEL ROAD APARTMENTS	Project address: CHAPEL ROAD, BANSTOWN (CAPR CHAPEL RD & ROCKWOOD RD)
Scale: 1:500 @ A1	Date: none
Drawing title: BASEMENT LEVEL, 1	
Project no.: 709	Drawing no.: R
DA109	6
Drawing status: FOR DA SUBMISSION	

BASIC SPECIFICATION
RESIDENTIAL – BLOCK A & B

Water: Rainwater collection: 10,000L.
Potable tank collecting from rooftop rainwater storage (approximate 775,04mm²)
– Water collected will be used for private & common area landscape irrigation.
3-star (Water Rating) – install 3-star showerheads, 4-star (Water Rating) toilets, 4-star (Water Rating) taps for kitchen & bathrooms.
– Dwellings must install 3-star (Water Rating) toilets, 4-star (Water Rating) taps for kitchen & bathrooms.
– Dwellings must install 3-star (Water Rating) taps for kitchen & bathrooms.
– Dwellings must install 3-star (Water Rating) Dishwasher.

[illegible]